

## Steel Joist Institute Bolted Anchorage Requirements for Joist or Joist Girders with Net Uplift

With the release of the 43<sup>rd</sup> edition Standard Specifications for steel joists and Joist Girders Vulcraft would like to notify our customers of some important changes in regards to the required end anchorage for uplift conditions.

### **Bolted Anchorage**

Typically, joists and Joist Girders with bolted end anchorage also require a final connection by welding in order to provide lateral stability to the supporting member. However, only the bolts are relied on to provide the uplift anchorage. The bolt type and diameter designation by the specifying professional shall provide sufficient tensile strength to resist the specified uplift end reaction. Higher strength bolts than the minimums required by the SJI Specification may be required.

When bearing seats have been detailed for a bolted condition, the bolts should be installed. “If bolts are not installed, an equivalent welded connection may be permitted by the specifying professional, provided the weld is deposited in the slot on the side farthest from the edge of the seat.” See Figure 1 below (ref. 43<sup>rd</sup> SJI p. 13)

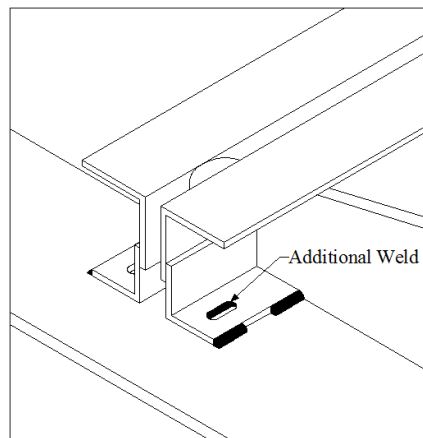

**Figure 1**